

# GROUND BAR CHAIR G75/90



**POSITIVE CLIP-ON**



**FITS STEEL 6 - 25mm**

***“What we like about Castle is they are always right there to help and have stock on hand”***

– John - Distributor

## The design specifics of our **G75/90 Ground Bar Chair**.

This chair is designed with the user and highest construction standards in mind.

The G75/90 is built to withstand high loading features include the handy clip on function so you can clip on to the mesh upside down and give the mesh a shake and all the chairs swing into place.

These chairs are batch tested and meet the AS/NZS 2425:2015 Standards for bar chairs in reinforced concrete.

### **Perfect For:**

Slab on ground applications, Trench bar supports, Driveways, Paths, Patios, Civil precast construction.

**PAGE 2**  
FOR MORE INFO



**0800 55 33 00**

## APPLICATIONS

- 150mm Slab on Ground
- Patios, Paths, Driveways
- Trench bar supports
- Civil Precast construction

## FEATURES AND BENEFITS

- Clip Style top
- Fits mesh/bar sizes 6-25mm
- Heavy duty stable support.

## TECHNICAL CHARACTERISTICS

Code	G75/90
Cover	75 & 90mm
Diameter	100mm
Colour	Multi
Bag Quantity	100 units
Bag Weight	4.3kg
Pallet Quantity	6000 units
Pallet Weight	290kg
Pallet Cubic Area (m <sup>3</sup> )	1.50m <sup>3</sup>
Test Standard	AS/NZS 2425:2015
H2S Resistance	A1 - Excellent*
Material	Polypropylene

\*Chemical Effect; Excellent. Satisfactory to 72°F (22°C)

## EVERYDAY APPLICATION

- Step 1: Clip Spacer to Mesh / Bar
- Step 2: Lift steel to let spacer swing around into position

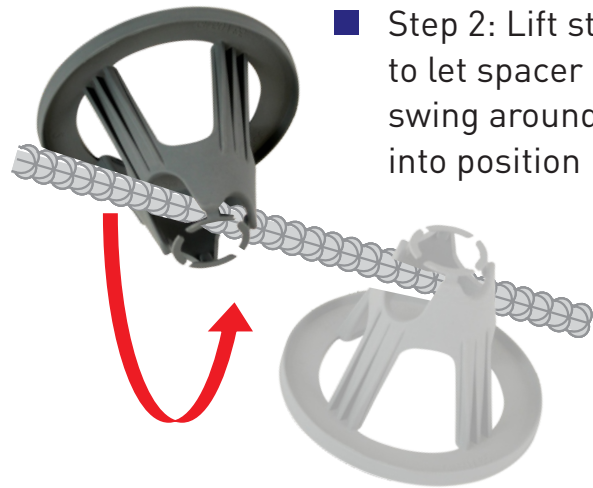

## TECHNICAL DIMENSIONS

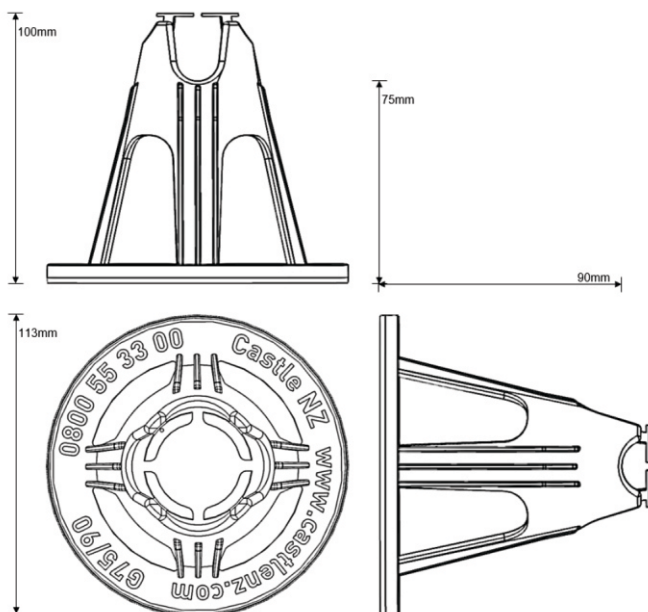

## TEST DATA

